

MADDEN PUMP

Heavy Duty, Industrial Mixers & Agitators



AA102A
High Speed Mixer



AA104
Medium Speed Mixer

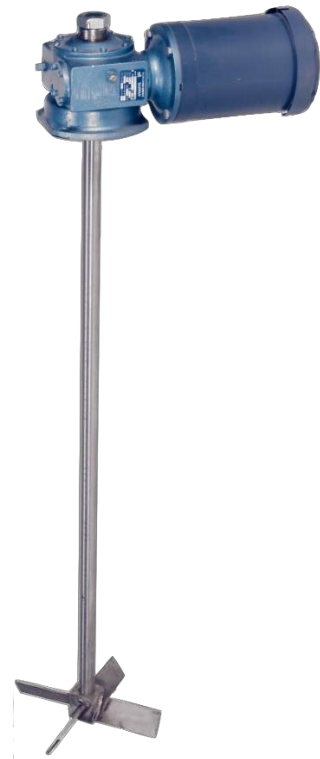

AA110
Low Speed Mixer

MADDEN Industrial Mixers

Madden offers three different lines of heavy duty, industrial mixers at an extremely competitive price. These mixers, also known as agitators, serve a vast array of industrial applications across the world; the mixing process and applications include, but are not limited to:

- Liquid Blending
- Solids Suspension
- Gas Dispersion
- Dissolving Solids
- Chemicals
- Mining processes
- Petroleum processes
- Slurries
- And more!

Mixer Model No. AA102A

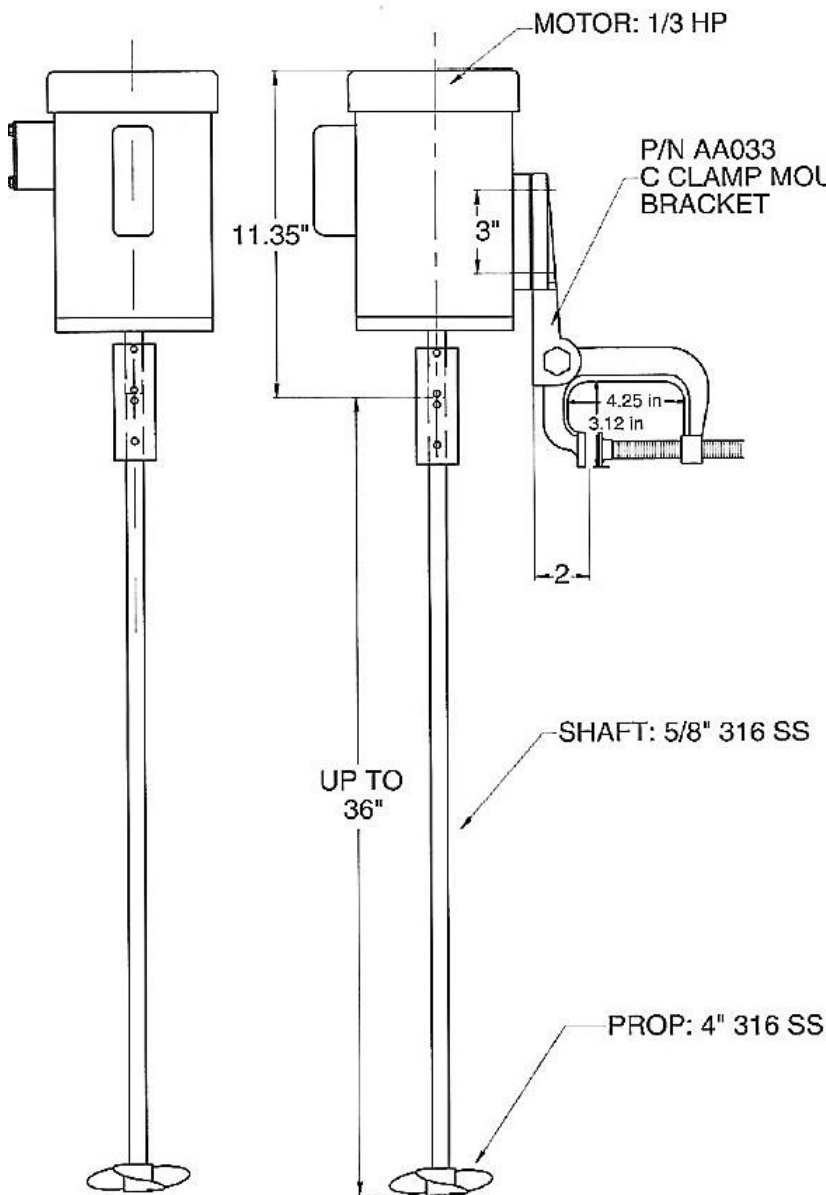

SPECIFICATIONS

- Speed: 1,725 rpm
- Propeller(s): 1 standard, multiple propellers optional. 4" diameter, 3 blade marine type, Material: 316 stainless steel
- Shaft: 5/8" 316 stainless steel, up to 36" long
- Motor: 1/3 HP, 1,725 rpm, TEFC, 1/60/115-230 or 3/60/230-460
- Mounting Options:
 1. (Standard) Mixer motor 56 frame foot pad can be used for rigid mounting.
 2. (Additional option) Mixer motor mounted to a C clamp for portable and adjustable mounting.Part number: AA033 (Page 8)

Mixer Model No. AA102AF

Variable Speed

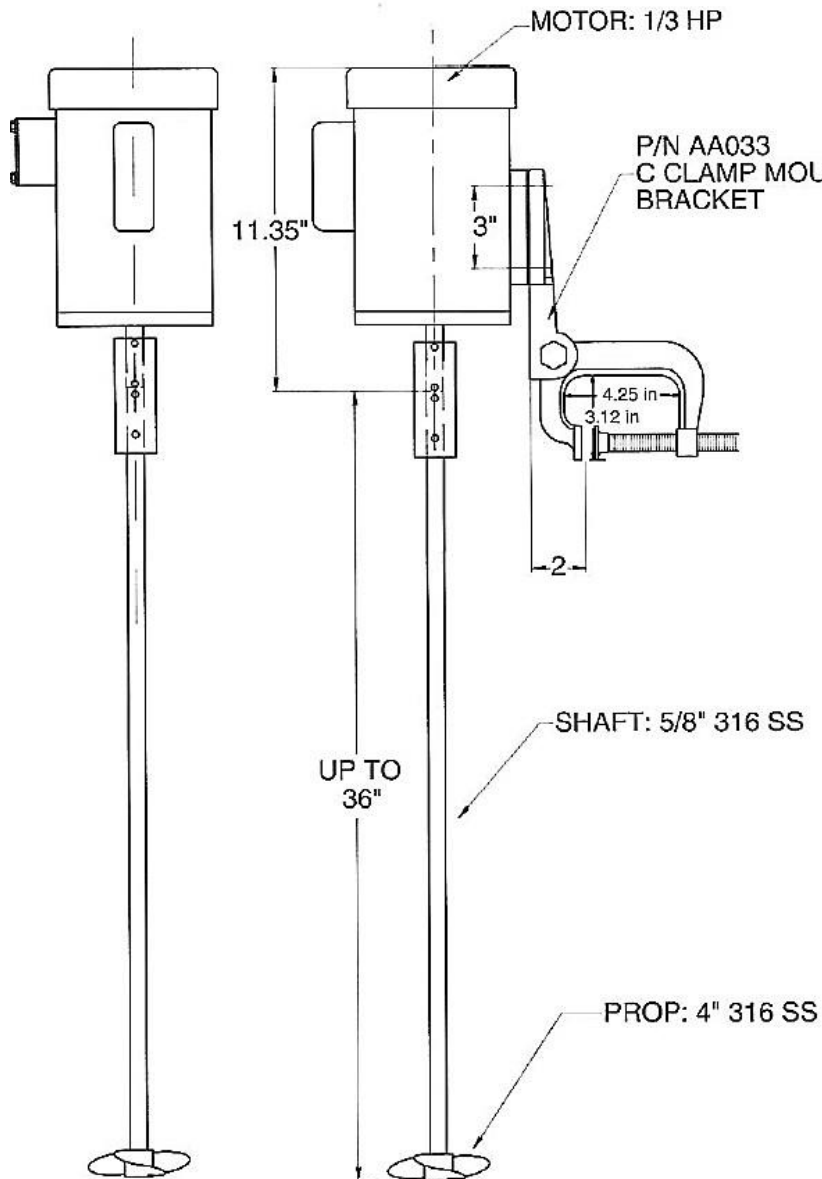

SPECIFICATIONS

- **Variable Speed:**
200-2,000 rpm
- **Propeller(s):** 1 standard, multiple propellers optional. 4" diameter, 3 blade marine type, Material: 316 stainless steel
- **Shaft:** 5/8" 316 stainless steel, up to 36" long
- **Motor:** 1/3 HP, 200-2,000 rpm, 3 PH, variable speed/inverter duty, TEFC
- **Variable Frequency Drive Controller:**
NEMA 4 enclosure, 1 PH or 3PH power options, 4-20 mA signal follower for remote speed control. The controller will be installed remote from the mixer motor. (Installation wiring not included)
- **Mounting Options:**
 1. (Standard) Mixer motor 56 frame foot pad can be used for rigid mounting.
 2. (Additional option) Mixer motor mounted to a C clamp for portable and adjustable mounting. Part number: AA033 (Page 8)

Mixer Model No. AA104

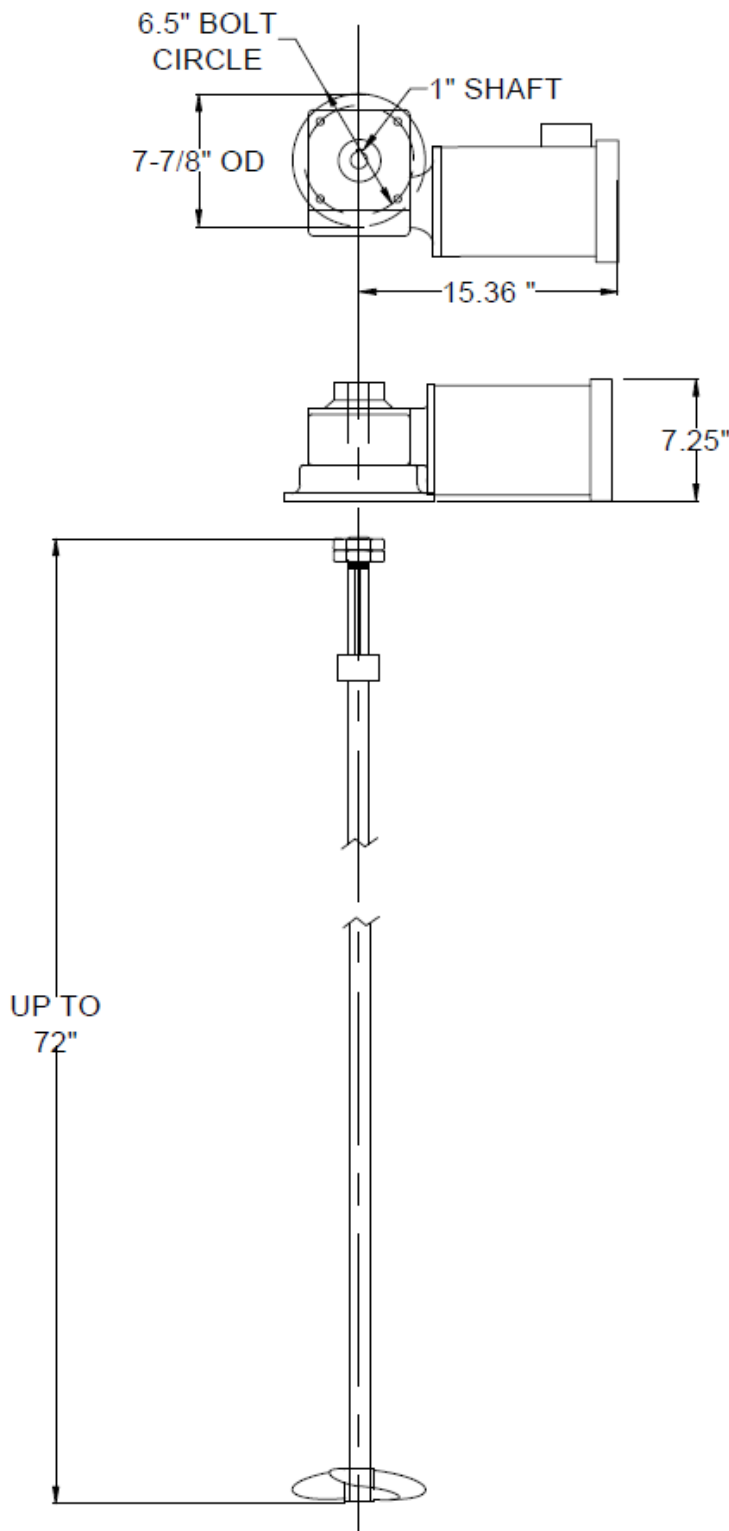

SPECIFICATIONS

- Speed: 345 rpm
- Propeller(s): 1 standard, multiple propellers optional.
8" diameter,
3 blade marine type,
Material: 316 stainless steel
- Shaft: 1" 316 stainless steel, up to 72" long
- Motor: 1,725 rpm, TEFC,
1/60/115-230 or 3/60/230-460
- Motor Sizes Available:
Model no. AA104A: 1/3 HP
Model no. AA104C: 1/2 HP
Model no. AA104D: 3/4 HP
Model no. AA104E: 1 HP
- Gear reducer: worm gear type,
5:1 gear ratio
Note: if an application requires it,
gear reducer can accommodate up
to a 5 HP motor. (Other gear ratios
available upon request for
alternative mixing speeds.)
- Mounting: (Additional option)
Rigid mount to fixed bridge type
structure to support mixer above a
tank.
Part numbers:
AA031 or AA032 (page 8)

Mixer Model No. AA104

Variable Speed

SPECIFICATIONS

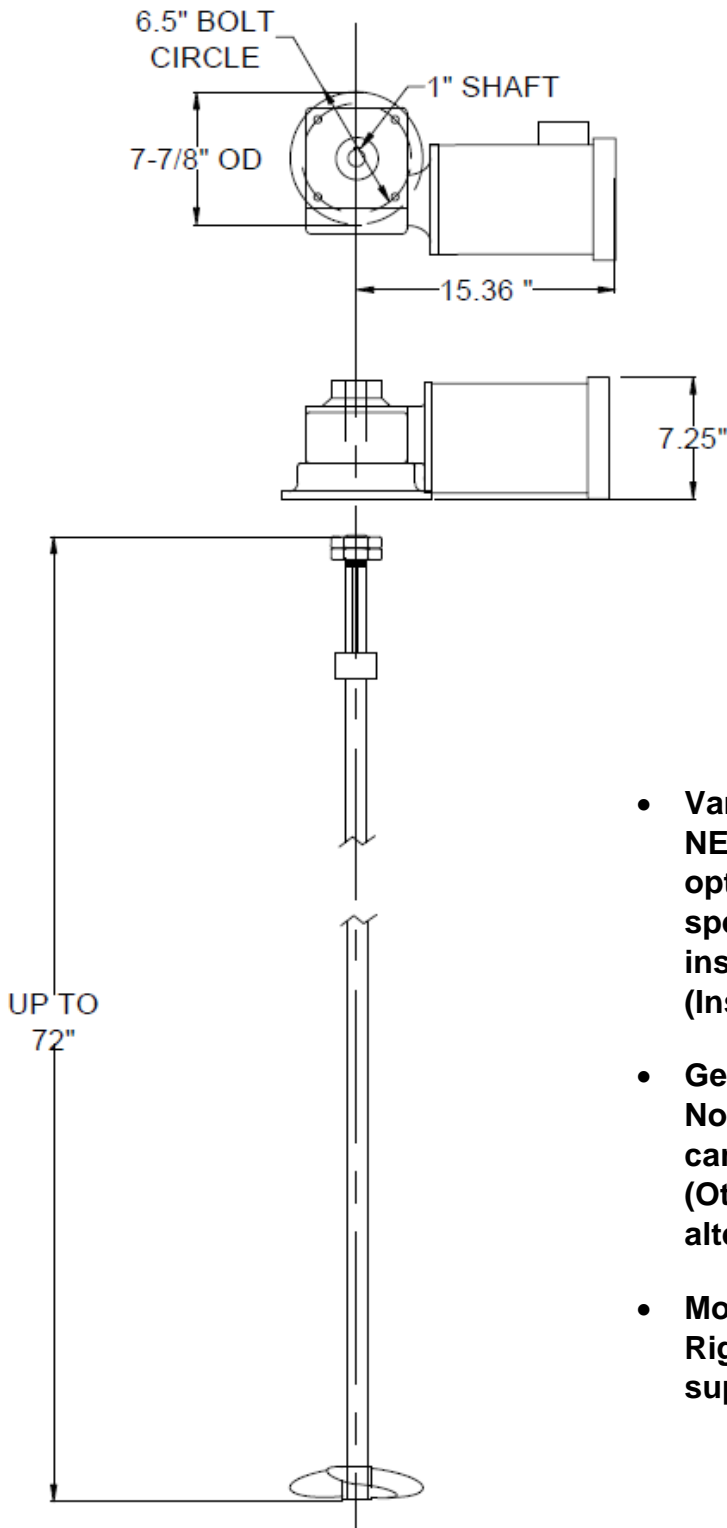

- Speed: 40-400 rpm
- Propeller(s): 1 standard, multiple propellers optional.
8" diameter,
3 blade marine type,
Material: 316 stainless steel
- Shaft: 1" 316 stainless steel, up to 72" long
- Motor: 200-2,000 rpm, 3 PH, variable speed/inverter duty, TEFC
- Motor Sizes Available:
Model no. AA104AF: 1/3 HP
Model no. AA104CF: 1/2 HP
Model no. AA104DF: 3/4 HP
Model no. AA104EF: 1 HP

- Variable Frequency Drive Controller: NEMA 4 enclosure, 1 PH or 3PH power options, 4-20 mA signal follower for remote speed control. The controller will be installed remote from the mixer motor. (Installation wiring not included)
- Gear reducer: worm gear type, 5:1 gear ratio
Note: if application requires it, gear reducer can accommodate up to a 5 HP motor. (Other gear ratios available upon request for alternative mixing speeds.)
- Mounting: (Additional option)
Rigid mount to fixed bridge type structure to support mixer above a tank.
Part numbers:
AA031 or AA032 (page 8)

Mixer Model No. AA110

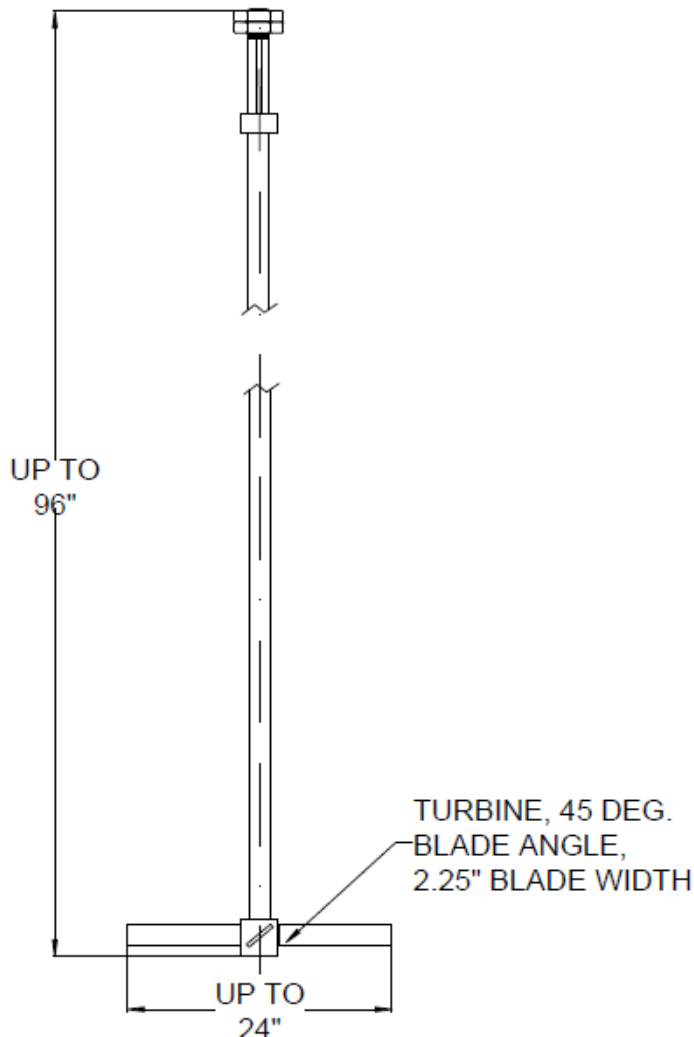
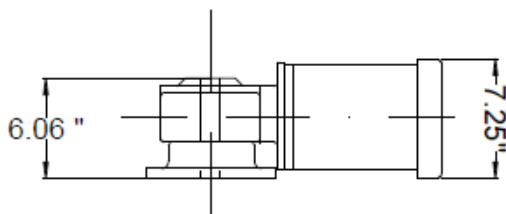
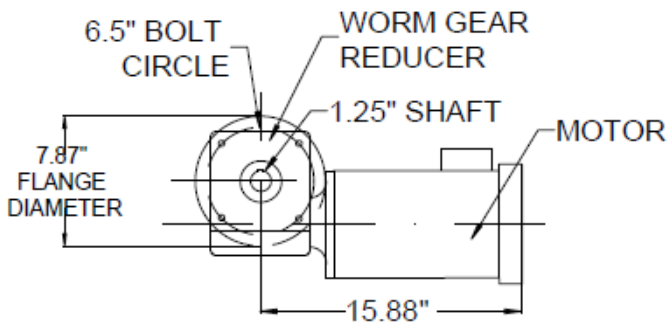

SPECIFICATIONS

- Speed: 57 rpm
- Propeller(s): 1 standard, multiple turbines optional.
4 blade turbine type,
Material: 316 stainless steel
- Turbine size:
16" up to 24" diameter
- Shaft: 1.25" 316 stainless steel, up to 96" long
- Motor: 1,725 rpm, TEFC,
1/60/115-230 or 3/60/230-460
- Motor Sizes Available:
Model no. AA110C: 1/2 HP
Model no. AA110D: 3/4 HP
Model no. AA110E: 1 HP
- Gear reducer: worm gear type, 30:1 gear ratio (note: other gear ratios available upon request for alternative mixing speeds)
- Mounting: (Additional option)
Rigid mount to fixed bridge type structure to support mixer above a tank.

Part numbers:
AA031 or AA032 (page 8)

Mixer Model No. AA110

Variable Speed

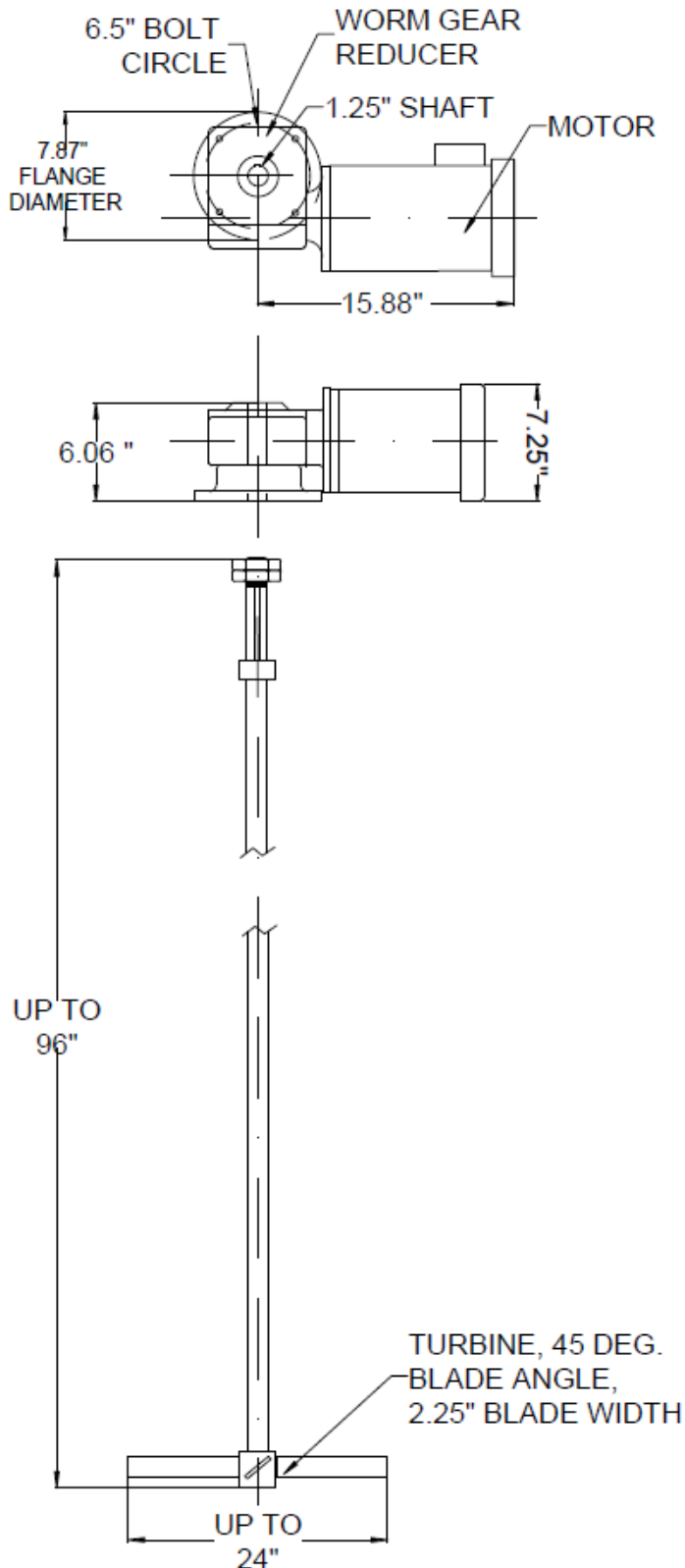

SPECIFICATIONS

- Speed: 6-66 rpm
- Propeller(s): 1 standard, multiple turbines optional.
4 blade turbine type,
Material: 316 stainless steel
- Turbine size:
16" up to 24" diameter
- Shaft: 1.25" 316 stainless steel, up to 96" long
- Motor: 200-2,000 rpm, 3 PH, variable speed/inverter duty, TEFC
- Motor Sizes Available:
Model no. AA110CF: 1/2 HP
Model no. AA110DF: 3/4 HP
Model no. AA110EF: 1 HP
- Variable Frequency Drive Controller:
NEMA 4 enclosure, 1 PH or 3PH power options, 4-20 mA signal follower for remote speed control. The controller will be installed remote from the mixer motor. (Installation wiring not included)
- Gear reducer: worm gear type, 30:1 gear ratio (note: other gear ratios available upon request for alternative mixing speeds)
- Mounting: (Additional option) Rigid mount to fixed bridge type structure to support mixer above a tank.
Part numbers:
AA031 or AA032 (page 8)

Mixer Mounting Brackets

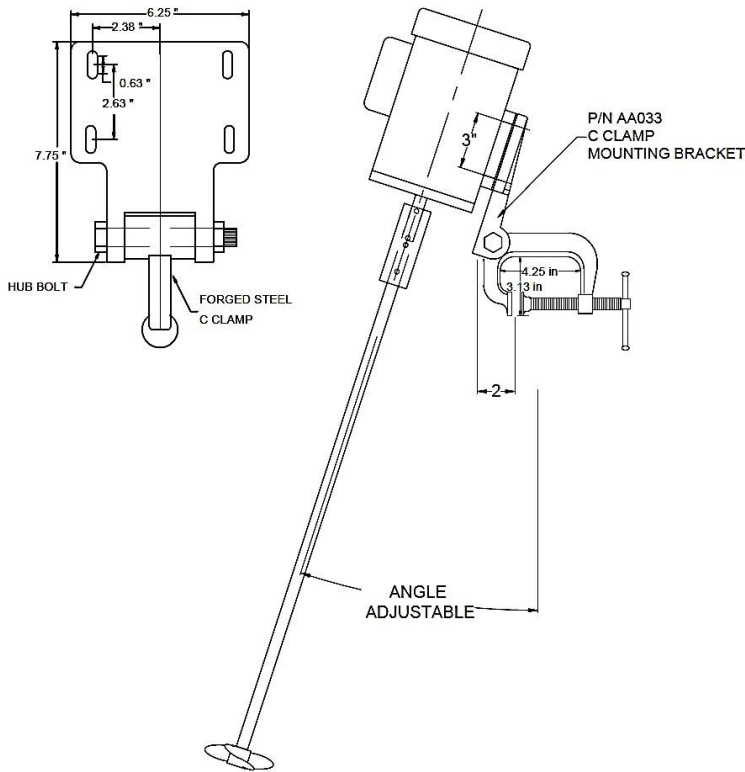

SPECIFICATIONS

Model No. AA033

C Clamp type mounting bracket for high speed mixer model AA102A

- Forged steel C clamp
- Cast iron motor mounting
- Angle adjustable
- Installs to rigid vertical support structure exterior to tank, or to reinforced pad on tank wall.
- Not recommended for mounting directly on plastic tanks.

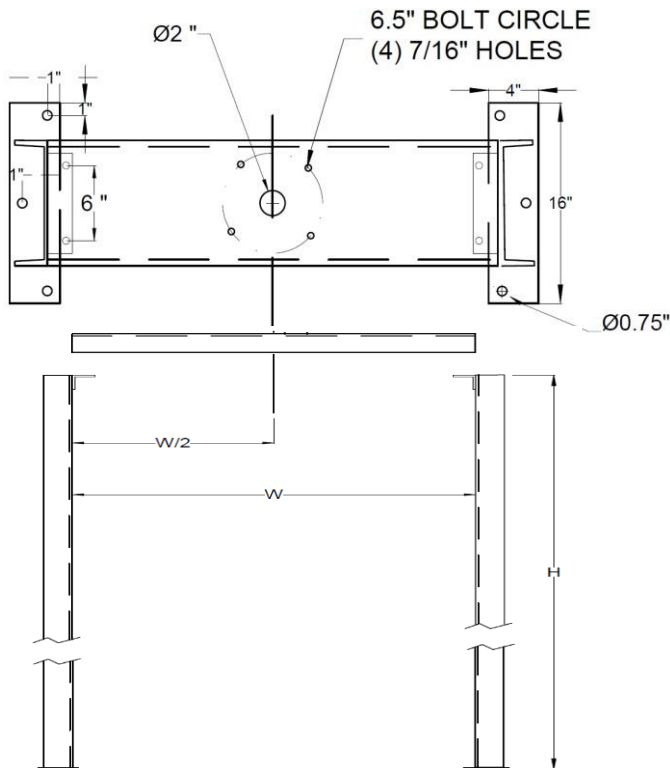

SPECIFICATIONS

Bridge type mixer mounting structure for geared mixers, models AA104 and AA110

- Part no. AA031 for tanks up to 48" wide and 60" tall. (6" C Channel)
- Part no. AA032 for tanks up to 72" wide and 96" tall. (10" C Channel)

MADDEN Pump

P.O. Box 387 • Elkhart, IN 46515 • USA
 Phone: (574) 295-4292 • Fax: (574) 295-7562
 Toll Free: 1-800-369-6233
 E-mail: info@maddenspump.com
 Website: www.Maddenspump.com

SOLD BY: